

L2102, L2103

PIN TYPE LEAD

Instruction Manual

Feb. 2022 Revised edition 3
L2102A980-03 22-02H

EN

HIOKI

www.hioki.com/



All regional
contact
information

HEADQUARTERS
81 Koizumi
Ueda, Nagano 386-1192 Japan

HIOKI EUROPE GmbH
Helfmann-Park 2
65760 Eschborn, Germany
hioki@hioki.eu

Edited and published by HIOKI E.E. CORPORATION

2111 EN
Printed in Japan

- CE declarations of conformity can be downloaded from our website.
- Contents subject to change without notice.
- This document contains copyrighted content.
- It is prohibited to copy, reproduce, or modify the content of this document without permission.
- Company names, product names, etc. mentioned in this document are trademarks or registered trademarks of their respective companies.

Introduction

Thank you for purchasing the HIOKI Model L2102, L2103 PIN TYPE LEAD. To obtain maximum performance from the product, please read this manual first, and keep it handy for future reference.

Overview

The conductive-tip contact pin of the model L2102 has a four-terminal structure that is developed for inspection of small devices, such as a terminal of a button cell battery. Use of the coaxial pin with an outside diameter of 1.8 mm makes it easy to contact an object to be measured, ensuring correct resistance measurement.

The conductive-tip contact pin of the model L2103 has a four-terminal structure that is developed for inspection of through holes, pads and surface mounted devices on a PCB. Parallel pins 0.2 mm apart are used and the tip is a four-sided pyramid. These make it easy to contact very small objects under measurement, and help measure a through hole efficiently.

Inspection and Maintenance

Initial Inspection

When you receive the product, inspect it carefully to ensure that no damage occurred during shipping. If damage is evident, or if it fails to operate according to the specifications, contact your dealer or Hioki representative.

Maintenance and Service

- To clean the product, wipe it gently with a soft cloth moistened with water or mild detergent. Never use solvents such as benzene, alcohol, acetone, ether, ketones, thinners or gasoline, as they can deform and discolor the case.
- If the product seems to be malfunctioning, contact your dealer or Hioki representative.
- Pack the product so that it will not sustain damage during shipping, and include a description of existing damage. We cannot accept responsibility for damage incurred during shipping.

Safety

This manual contains information and warnings essential for safe operation of the product and for maintaining it in safe operating condition. Before using it, be sure to carefully read the following safety precautions.

DANGER

Mishandling this product during use could result in injury or death, as well as damage to the product. Be certain that you understand the instructions and precautions in the manual before use. We disclaim any responsibility for accidents or injuries not resulting directly from product defects.

Safety Symbol

	In the manual, the symbol indicates particularly important information that the user should read before using the product.
	Indicates DC (Direct Current).
	This symbol indicates that the product conforms to regulations set out by the EU Directive.

The following symbols in this manual indicate the relative importance of cautions and warnings.

DANGER

Indicates that incorrect operation presents an extreme hazard that could result in serious injury or death to the user.

CAUTION

Indicates that incorrect operation presents a possibility of injury to the user or damage to the product.

NOTE

Indicates advisory items related to performance or correct operation of the product.

Usage Notes



Follow these precautions to ensure safe operation and to obtain the full benefits of the various functions.

DANGER

- To avoid electrical shock, be careful to avoid shorting live lines with the Pin type leads.
- The maximum rated voltage between input terminals and ground is 30 V rms, 42.4 Vp AC and 60 V DC. Attempting to measure voltages exceeding these limits with respect to ground could damage the product and result in personal injury.
- The maximum input current is as follows;
The model L2102: 3 A AC/DC
The model L2103: 2 A AC/DC
Never exceed this limit, as doing so could result in destruction of the instrument and personal injury or death.
- To avoid shock and short circuits, turn off all power before connecting leads.

CAUTION

- To avoid damage to the product, protect it from physical shock when transporting and handling. Be especially careful to avoid physical shock from dropping.
- To avoid damage to the product, do not use the product where it may be exposed to oil, chemicals, or solvents.
- To avoid breaking the leads, do not bend or pull them.
- Avoid stepping on or pinching cables, which could damage the cable insulation.
- Do not curl the cable near the cable lock.
- It may damage the core wire or the covering.
- Do not bend it continuously.
- The ends of the leads are sharp. Be careful to avoid injury. Fit the protective pin cap when the product is not in use.
- To prevent damage to the instrument, press the tip pin perpendicularly against a sample.

Parts Names

The model L2102 PIN TYPE LEAD

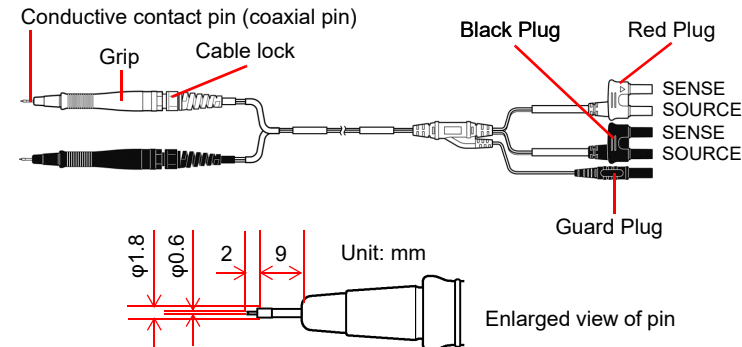

The model L2103 PIN TYPE LEAD

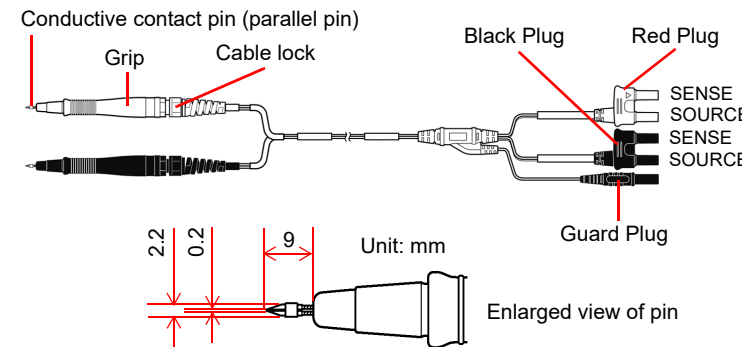

Procedure

Preliminary Checks

Before using the product the first time, verify that it operates normally to ensure that no damage occurred during storage or shipping. If you find any damage, contact your dealer or Hioki representative.

DANGER

Before using the product, make sure that the insulation on the test leads is undamaged and that no bare conductors are improperly exposed. Using the product in such conditions could cause an electric shock, so contact your dealer or Hioki representative for repair.

Conductive contact pin (coaxial)

1. Make sure that power of the device to connect the pin type lead to is off.
2. Connect the pin type lead to the input terminal of the device.

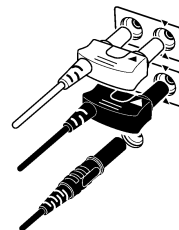

Plug the ▲ mark on the red lead into the red ▲ marked jack on the instrument, and plug the ▲ mark on the black lead into the black ▲ marked jack on the instrument.

3. Connect the model L2102 / L2103 to a sample.

NOTE

- Zero adjustment cannot be performed with the model L2102, L2103. Use the model L2101 clip type lead for zero adjustment. For details on zero adjustment, please refer to the instruction manuals of the connecting devices.
- Fit the cap after use.

Replacing the Pin

The conductive-tip contact pin is replaceable. Replace the pin with a new one if it is broken or worn. One-piece conductive-tip contact pins with a plastic pin base are available separately.

1. Turn off power of the device before connecting the pin type lead.
2. Unscrew the cable lock to unlock the cable.
(The cable is locked by screwing the cable lock.)

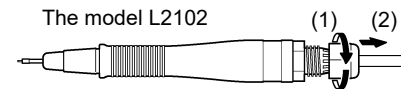

To prevent broken wires; do not pull the cable, and do not twist the cable.

3. Hold the pin base so that the cable won't rotate, and then rotate the grip to loosen it.

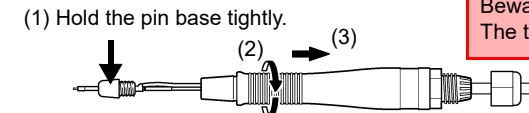

Beware of injury. The tip has a sharp point.

4. Pull off the connector and remove the pin.

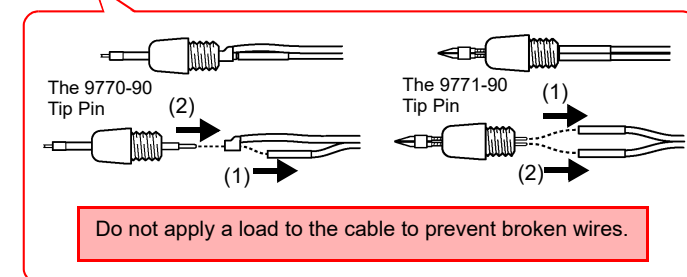

5. Fasten a new pin. Press the tip of the pin against a desk so that the pin won't spring out, and push the connector onto the pin.



The red shrink tube should not come out.

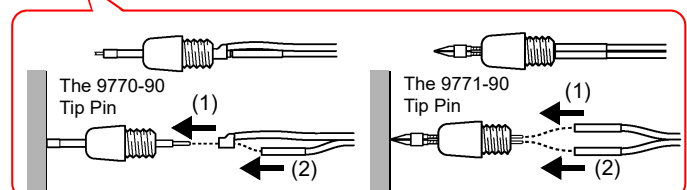

6. Assemble the pin type lead in the reverse order of disassembling. Do not pull or twist the cable.
7. To avoid broken wires and contact failures, after tightening the cable lock, gently tug and twist the cable to check it is firmly held.
8. Check the performance. Measure an object with a known resistance. Make sure that the measured resistance is correct before using the pin type lead.

Specifications

Maximum rated voltage to earth	30 V rms or less, 42.4 Vp AC or less and 60 V DC or less
Maximum input current	Model L2102: AC/DC 3 A continuous Model L2103: AC/DC 2 A continuous
Operating temperature and humidity	0°C to 40°C (32°F to 104°F), 80% RH or less (no condensation)
Storage temperature and humidity	-10°C to 50°C (14°C to 122°C), 80% RH or less (no condensation)
Operating Environment	Altitude up to 2000 m (6562 feet), Indoor Pollution Degree 2
Size&Weight	Approx. 1500 mm (59.06")/ Approx. 180 g (6.3 oz.)
Accessories	Instruction manual
Options	Model L2102: 9770-90 Tip Pin Model L2103: 9771-90 Tip Pin

The options listed above are available for the product. Contact your authorized Hioki distributor or reseller when ordering. The options are subject to change. Visit our website for updated information.